

## APPENDIX C

### SITE PLANS

**COPPIN STATE UNIVERSITY PUBLIC SAFETY FACILITY**

2500 WEST NORTH AVENUE  
BALTIMORE, MD 21216

KEYMAP

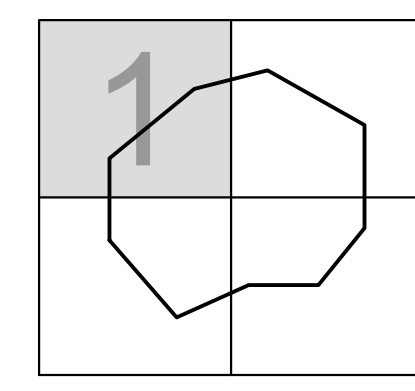

REVISIONS

#	DATE	DESCRIPTION

DRAWN BY: NCF      CHECKED BY: KHM  
DATE: 01/31/2022      PROJECT #: 22001  
SCALE: AS NOTED  
DRAWING NAME:

**SWM CONCEPT**  
**NOT FOR CONSTRUCTION**

DRAWING NO.: **Site 1**

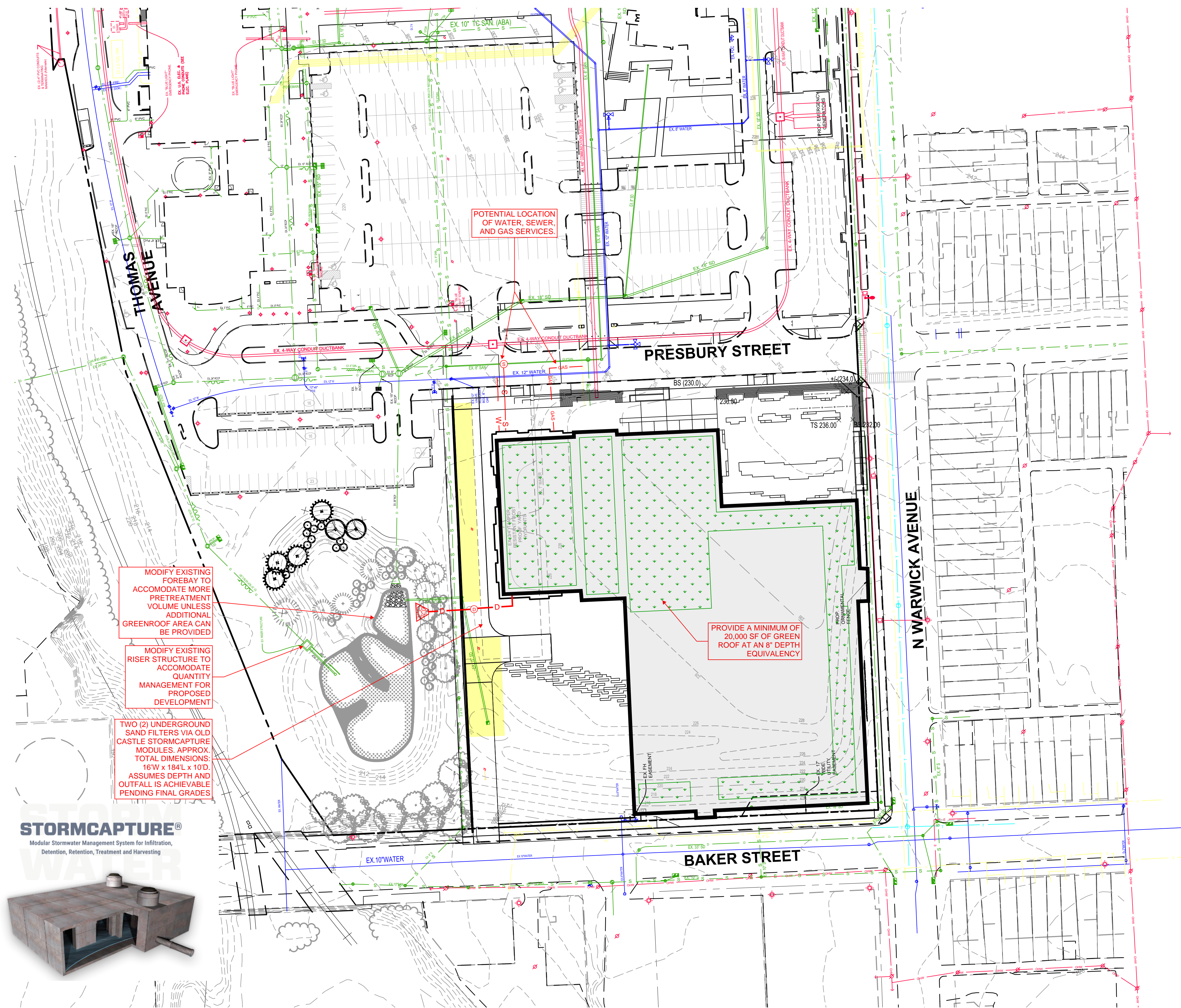

MODIFY EXISTING FOREBAY TO ACCOMMODATE MORE PRETREATMENT VOLUME UNLESS ADDITIONAL GREENROOF AREA CAN BE PROVIDED

MODIFY EXISTING RISER STRUCTURE TO ACCOMMODATE QUANTITY MANAGEMENT FOR PROPOSED DEVELOPMENT

TWO (2) UNDERGROUND SAND FILTERS VIA OLD CASTLE STORMCAPTURE MODULES. APPROX. TOTAL DIMENSIONS: 16'W x 184'L x 10'D. ASSUMES DEPTH AND OUTFALL IS ACHIEVABLE PENDING FINAL GRADES

PROVIDE A MINIMUM OF 20,000 SF OF GREEN ROOF AT AN 8" DEPTH EQUIVALENCY

**STORMCAPTURE®**  
Modular Stormwater Management System for Infiltration, Detention, Retention, Treatment and Harvesting

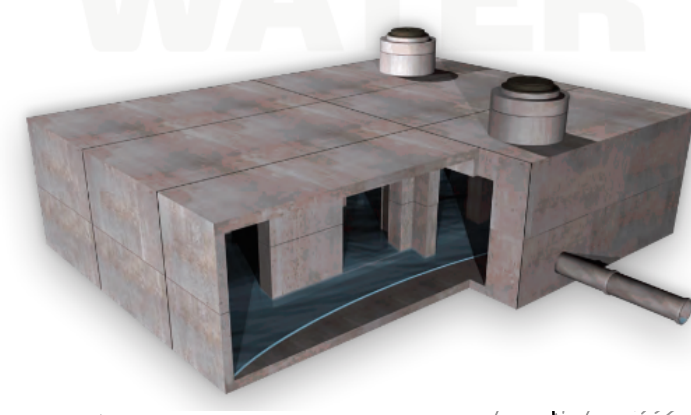

2022.11.17 - SITE 2 SRI SWM CONCEPT

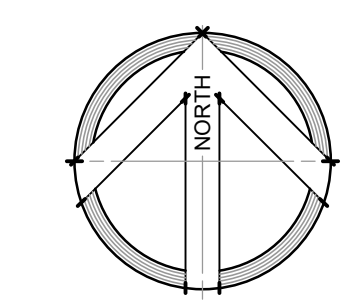
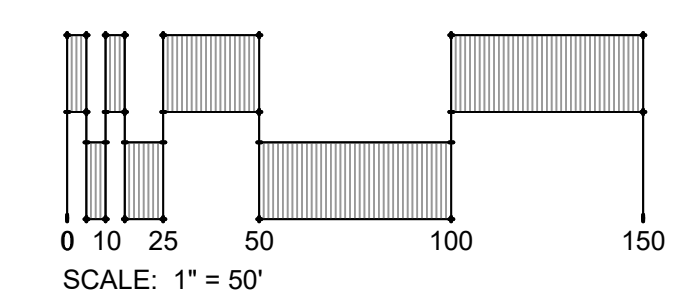

**COPPIN STATE UNIVERSITY PUBLIC SAFETY FACILITY**

2500 WEST NORTH AVENUE  
 BALTIMORE, MD 21216

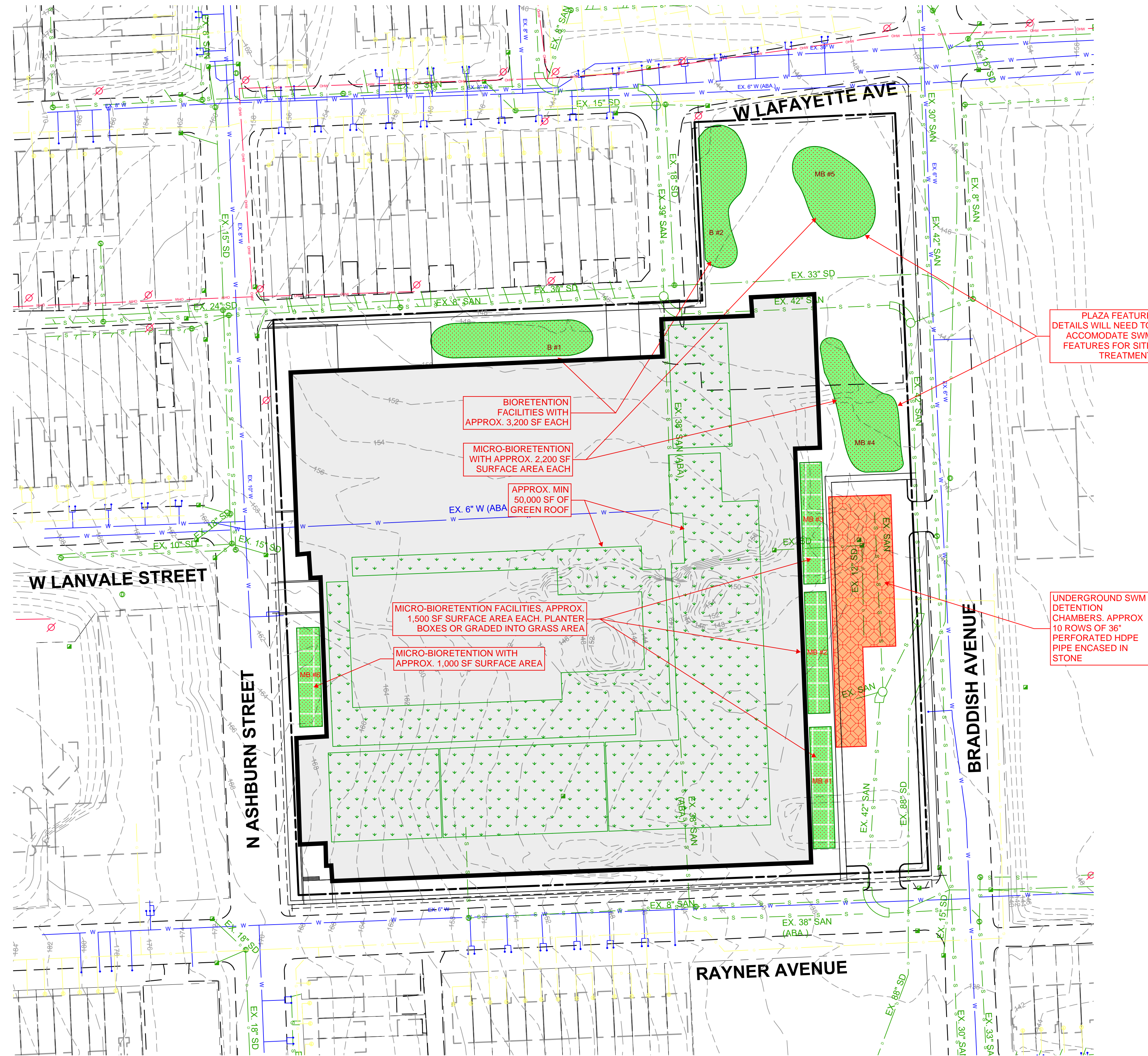

2022.11.17 - SITE 2 SRI SWM CONCEPT

**REVISIONS**

#	DATE	DESCRIPTION

DRAWN BY: NCF CHECKED BY: KHM  
 DATE: 01/31/2022 PROJECT #: 22001  
 SCALE: AS NOTED  
 DRAWING NAME:

**SWM CONCEPT**  
**NOT FOR CONSTRUCTION**

DRAWING NO.:

**Site 2**

